

Welcome to stablelab

5/25 pack



STANDARD MODE → Flip switch to the left

Best for running one test at a time. The reader will time the test and display result after 10 minutes.



Collect whole blood* from the end of the syringe using the BloodCaptor™.

*If using serum or plasma refer to page 8 of the User Manual.



Remove the mix solution bottle cap. Firmly insert the BloodCaptor collection arm with blood-filled bulb completely into the mix solution so that a tight seal is formed. Gently agitate the contents and run the sample promptly. Gently squeeze the bottle to discard the first few drops.



Insert the Test Cartridge into the Stablelab Reader. This will automatically turn on the reader and display "Apply Sample".



Apply 4 drops to the cartridge well. The reader will detect the sample within 60 seconds of application and will initiate an automatic 9-minute countdown.



After 10 minutes, the result is displayed for 20 seconds before reader powers down to conserve energy.



The result is stored until the cartridge is removed. Remove the cartridge and the result will display on the screen for 5 seconds before being deleted from the device.

zoetis



QUICK MODE → Flip switch to the right

Best for running multiple samples sequentially to save time. Each test is timed by you and the reader will give an instantaneous result when inserted at the 10 minute mark.



Collect whole blood* from the end of the syringe using the BloodCaptor™.

*if using serum or plasma refer to page 8 of the User Manual.



Remove the mix solution bottle cap. Firmly insert the BloodCaptor collection arm with blood-filled bulb completely into the mix solution so that a tight seal is formed. Gently agitate the contents, squeeze the bottle to discard the first few drops and run the sample promptly.



Label the mix solution bottle and the test cartridge with the patient's name and note the time drops applied. Apply 4 drops of solution from the bottle into the well of the test cartridge. Set timer for 10 minutes.

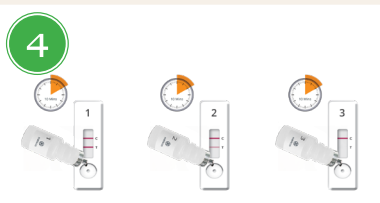

Repeat Steps 1-3 with a new test cartridge for each sample needing to be run. Keep cartridges on a flat horizontal surface while developing.



After 10 minutes, insert the test cartridge into the reader. The Test and Control window should be facing up and forward. The reader will power on and the result will be immediately displayed for 20 seconds before being permanently deleted from the device.



After the SAA result is displayed and recorded, remove the test cartridge and insert the next as each additional test reaches the 10-minute mark.**

** It is critical to read each test cartridge at exactly 10 minutes because the Test and Control lines continue to develop over time. Inserting the cartridge beyond the 10-minute mark will falsely elevate the SAA value measured. Conversely, inserting a cartridge before 10 minutes have passed will read a lower SAA value than present.



Scan to access the User Manual

Learn more from your Zoetis Equine Specialist and visit **stablelab.com**

Help your clients learn more about Stablelab:
www.zoetisequine.com/stablelab

Follow us!



@ZoetisEquine



@zoetisequine



Zoetis Equine

All trademarks are the property of Zoetis Services LLC or a related company or a licensor unless otherwise noted. Stablelab is a registered trademark of Epona Biotech Limited, used under license.

© 2023 Zoetis Services LLC. All rights reserved. STB-00192

zoetis